

INTERMOBILIARIA

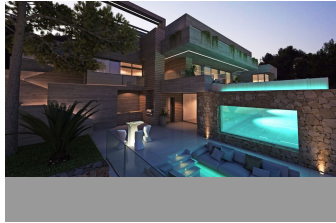
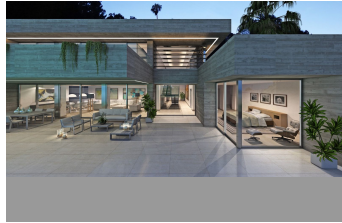
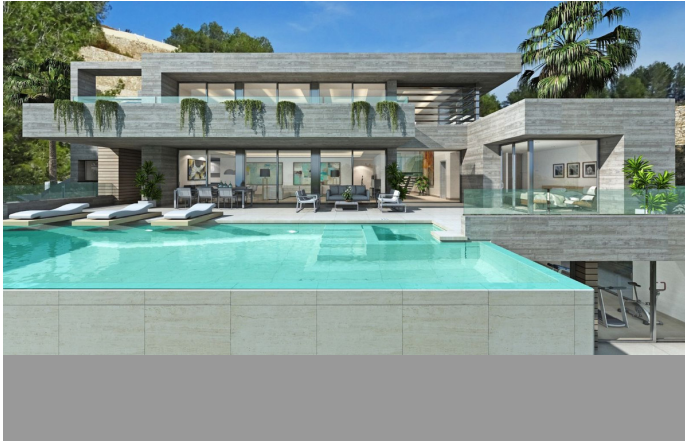

Detached Villa in Benahavís – 5 bedrooms – 7 baths

Bedrooms	5	Bathrooms	7	Built	1070m2	Plot	5000m2
R4629583		property		Benahavís		4.695.000€	

OFF-PLAN LUXURY ECOLOGICAL CONTEMPORARY VILLA- KEY-IN-HAND PROJECT ON A HUGE PLOT –BENAHAVIS only 4,9 km from the beaches in San Pedro de Alcantara and will be built on 3 floors. Ground floor: Entrance hall with guest toilet, cloakroom, staircase to the basement and elevator, living/dining area, open plan kitchen, fully fitted with Bosch white goods and pantry, 1 bedroom with ensuite bathroom, and the master bedroom with dressing and ensuite bathroom. There will be a huge terrace with a heated pool and an outside staircase that leads to the lower level and sitting area. First floor: 2 bedrooms with 2 bathrooms, storage room and a bedroom with dressing and ensuite bathroom, all bedrooms have access to a huge terrace. Basement/garage: garage for at least 4 cars and separate storage room, distributor, technical room, gymnasium, cinema room, diaphanous room, and 2 storage rooms, furthermore on this level you also have a sitting area. On the terrace, you have a chill-out-sitting area with an outdoor kitchen and views into the pool. Pictures of the bathrooms and kitchen are only examples final choice of the finishings shall be for the client within the chosen line that we propose. Example of some of the specifications, - Interior and exterior floor tiles from GRESANIA 600x600 – 800x800 - 1200x1200 (Color and size to choose) - Bathroom walls with COVERLAM plates (GRESANIA) 2700X1200 (Color to choose) - Bathrooms from ROCA – DURAVIT – VILLEROY BOCH – GEBERIT – HANSGROHE OR SIMILAR - Aerothermia/airconditioning - Elevator from Schindler or similar - Underfloor heating in the full villa - Ceiling high windows with a sunken track, 5+5/chamber/6+6 - Ceiling high and 1-meter wide interior doors - Fully fitted kitchen with aluminum frame doors and covered with COVERLAM (Color to choose) - Island with COVERLAM 3600X1600 no visible joints (Color to choose) - White goods from Bosch or AEG - Heated pool - 30 solar panels - 3 lithium batteries of each 10kW - Car charger - Domotica We are a construction company, Key-in-Hand, that can design and construct any

possibility you can think of. If you do not see a design of us that you like we design a totally new villa for you according to your ideas and input. Although we prefer to construct ecological building, we can construct from traditional construction to ecological constructions it all depends on you.

Access for people with reduced mobility	Access for people with reduced mobility	Barbeque
Basement	Covered Terrace	Domotics
Double Glazing	Ensuite Bathroom	Fiber Optic
Fitted Wardrobes	Games Room	Gym
Lift	Private Terrace	Solarium
Storage Room	Utility Room	WiFi